

STANDARD ACCESSORIES

# DC-10 SPLIT COUPLERS

The DC-10 Split coupler is a 2-piece coupler that provides a water-tight and air-tight connection in buried and underground applications with a high pull-out strength. The clam-shell design allows users to easily access the cable after the coupler is installed.

- ▶ High pull-out strength
- ▶ Easy Installation
- ▶ 2-piece design
- ▶ Metal finish

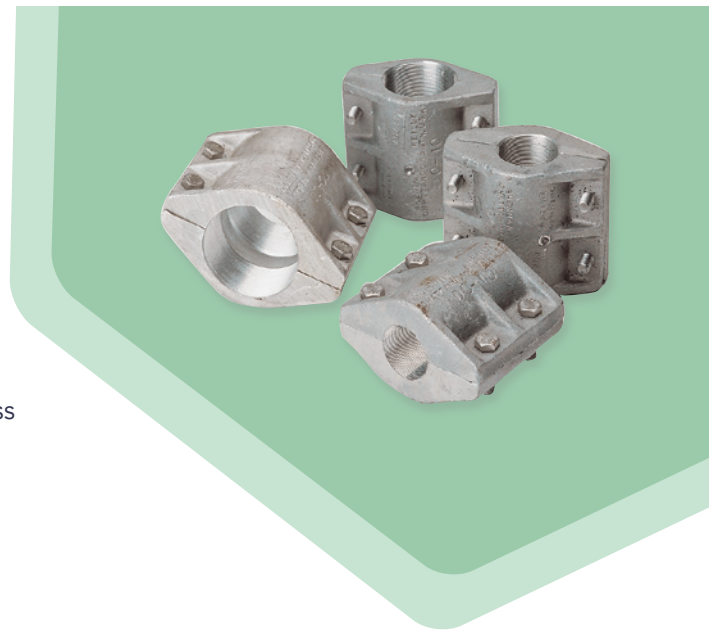

ORDER REFERENCE

| DESCRIPTION              | DUCT OD   | UOM | DURA-LINE PART # |
|--------------------------|-----------|-----|------------------|
| 1" DC-10 Hybrid          | 1.350" OD | EA  | 20001848         |
| 1" DC-10 SDR 11/13.5     | 1.315" OD | EA  | 20003092         |
| 1 1/4" DC-10 SDR 11/13.5 | 1.660" OD | EA  | 20001952         |
| 1 1/4" DC-10 True SDR 9  | 1.590" OD | EA  | 20001849         |
| 1 1/2" DC-10 SDR 11/13.5 | 1.900" OD | EA  | 20003660         |
| DH-10 Duct Holder        | n/a       | EA  | 20003326         |